

# WESTGATE NORTH SHOPPING CENTER

2601 N. Pearl Street | Tacoma, WA 98407

| SPACE | TENANT                   | SQ. FT.  |       |                               |               |
|-------|--------------------------|----------|-------|-------------------------------|---------------|
|       |                          |          | 2633  | Key Bank                      | 3,500 SF      |
| G1    | The Habit Burger Grill   | 2,406 SF | 2661  | The UPS Store                 | 1,900 SF      |
| 103   | Oddfella's Pub & Eatery  | 3,765 SF | 2665  | Pet Pros                      | 2,904 SF      |
| 115   | Franciscan Health System | 8,683 SF | 2719  | Soundview Veterinary Hospital | 2,500 SF      |
| 240   | Comcast Xfinity          | 2,400 SF | 2723  | Subway                        | 1,250 SF      |
| 245   | Oscar Nail Salon And Spa | 2,600 SF | 2725  | Souper Pho                    | 1,250 SF      |
| 500   | Big Chicken              | 2,800 SF | 2729  | Tacoma Smiles Dentistry       | 3,452 SF      |
| 2615  | Taco Bell                | 2,304 SF | 5701  | Elite Physical Therapy        | 3,666 SF      |
| 2621  | Great Clips              | 1,072 SF | 5705  | 911 Driving School            | 1,596 SF      |
| 2623  | Anytime Fitness          | 4,500 SF | 5705A | AVAILABLE                     | 3,502 SF      |
| 2625  | Seattle Sun Tan          | 2,020 SF | 5719  | Flying Fish Sushi Bar & Grill | 1,400 SF      |
| 2627  | Westgate Liquor and Wine | 5,238 SF | 5719A | AVAILABLE                     | 1,546 SF      |
| 2629  | Round Table Pizza        | 5,000 SF | 5723  | Chase Bank                    | 3,564 SF      |
|       |                          |          |       | <b>TOTAL SQ. FT.</b>          | <b>74,818</b> |

| SITE LEGEND   |   |
|---|---|
| <span style="background-color: #FFC000; border: 1px solid black; display: inline-block; width: 15px; height: 10px;"></span> Available             | <span style="background-color: #D3D3D3; border: 1px solid black; display: inline-block; width: 15px; height: 10px;"></span> Occupied        |
| <span style="background-color: #ADD8E6; border: 1px solid black; display: inline-block; width: 15px; height: 10px;"></span> Leased (not occupied) | <span style="background-color: #808080; border: 1px solid black; display: inline-block; width: 15px; height: 10px;"></span> Owned by Others |
| <span style="border: 2px dashed blue; display: inline-block; width: 15px; height: 10px;"></span> Site Boundary                                    |   |

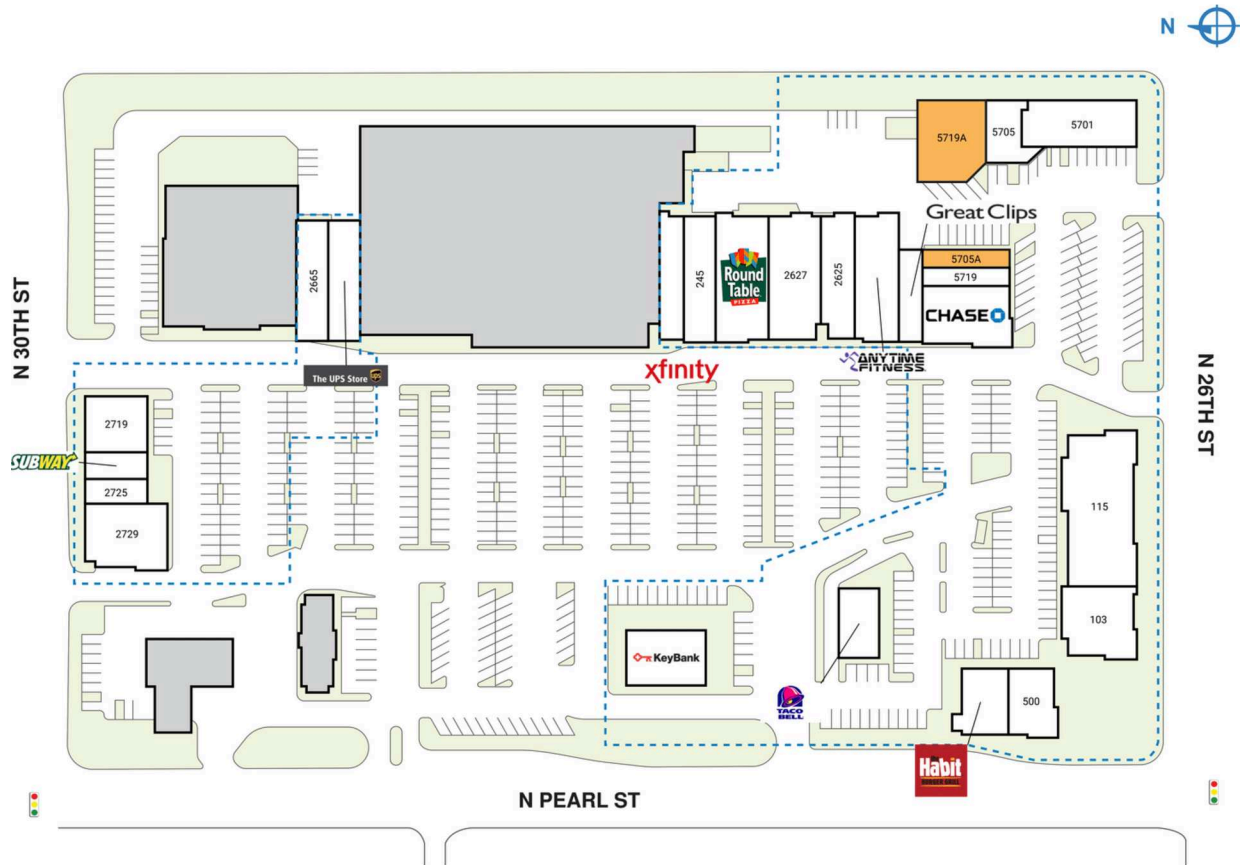

DISCLAIMER - This site plan is for general information purposes only and is not intended to constitute representations and warranties by Landlord as to the ownership of the real property depicted herein or the identity or nature of any occupants thereof.