

# SHOPPES OF LAKE VILLAGE

10601 US-441 | Leesburg, FL 34788

SPACE	TENANT	SQ. FT.			
A1	AI Juice	1,000 SF	C1B	Leading Edge Dental	1,700 SF
A2	Phillip Tailor and Alterations	1,000 SF	C2	Salon Suites	2,975 SF
A3	Connect Hearing	1,250 SF	C4	Lake Uniforms	1,700 SF
A5	Tobacco Planet	750 SF	C5	AVAILABLE	2,550 SF
A6	The Best in Town Barbershop	1,750 SF	C7	Mariner Finance	1,700 SF
A8	H&R Block	1,000 SF	C8	Eye Doctors Optical Outlet	2,975 SF
B	Advance Auto Parts	8,640 SF	CMT79	Chase Bank	
C10	The UPS Store	1,275 SF	D	Publix	48,387 SF
C12	Kawachi Sushi & Bar	3,779 SF	E3	Sproutfitters	12,223 SF
C13	Play It Again Sports	4,266 SF	E8	Dollar Tree	9,592 SF
C14	OneBlood	3,636 SF	G1	AVAILABLE	3,850 SF
C15	China Liu	2,465 SF	G2	Tropical Smoothie Cafe	1,400 SF
C17	Publix Liquors	1,740 SF	OUT1	Arby's	3,500 SF
C18	Gino's Pizza	1,275 SF	OUT2	VIPcare	2,894 SF
C19	AVAILABLE	1,971 SF	OUT3	7 Brew	
C1A	Elegant Nails and Tanning	1,530 SF	I	AVAILABLE	
			TOTAL SQ. FT.		136,273

<span style="background-color: orange; border: 1px solid black; display: inline-block; width: 15px; height: 10px;"></span> Available	<span style="background-color: lightgray; border: 1px solid black; display: inline-block; width: 15px; height: 10px;"></span> Occupied
<span style="background-color: lightblue; border: 1px solid black; display: inline-block; width: 15px; height: 10px;"></span> Leased (not occupied)	<span style="background-color: gray; border: 1px solid black; display: inline-block; width: 15px; height: 10px;"></span> Owned by Others
<span style="border: 2px dashed blue; display: inline-block; width: 15px; height: 10px;"></span> Site Boundary	

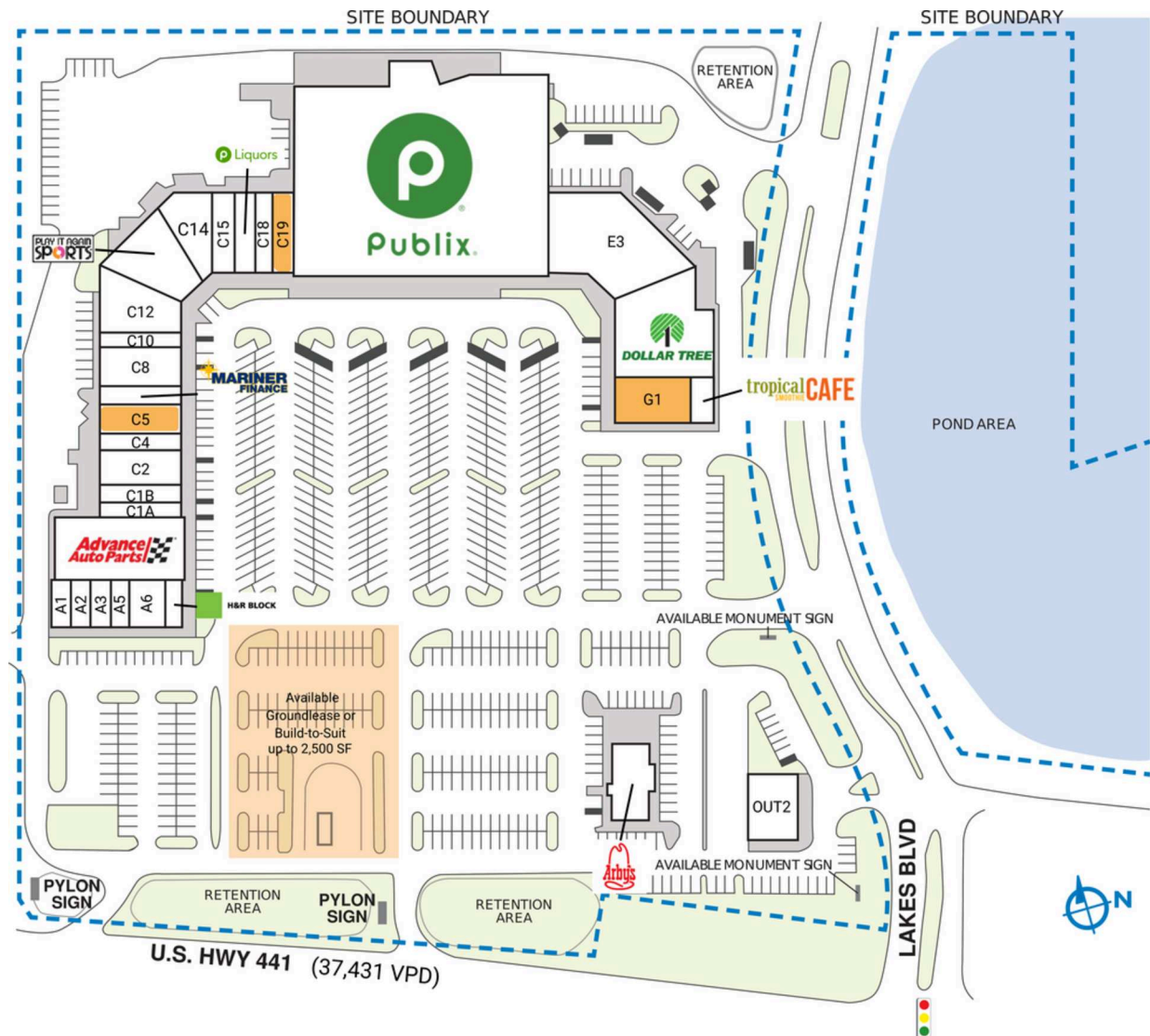

DISCLAIMER - This site plan is for general information purposes only and is not intended to constitute representations and warranties by Landlord as to the ownership of the real property depicted herein or the identity or nature of any occupants thereof.