





# TOWN CENTER AT JENSEN BEACH

4163 NW Federal Highway | Jensen Beach, FL 34957

SPACE	TENANT	SQ. FT.
OUT2	Culver's	4,400 SF
07	Parent's Choice Preschool	8,750 SF
08	China Kitchen	1,050 SF
11	All Partners Network	3,850 SF
12	Publix	51,420 SF
13	Virginia's Hair Salon	1,050 SF
14	Certified Doodle	1,074 SF
16	Orangetheory Fitness	2,790 SF
17	Nail Trust	1,050 SF
18	Audio Nova	1,050 SF
20	Schwerer Dental Care	2,450 SF
21	Coastal Animal Hospital	1,400 SF
<b>22A</b>	<b>COMING AVAILABLE</b>	<b>12,400 SF</b>
22B	Buddy's Home Furnishings	3,608 SF
22CD	ABA Centers of Florida	5,707 SF
<b>23</b>	<b>AVAILABLE</b>	<b>7,277 SF</b>
<b>TOTAL SQ. FT.</b>		<b>109,326</b>

SITE LEGEND	
	Available
	Leased (not occupied)
	Occupied
	Owned by Others
	Site Boundary

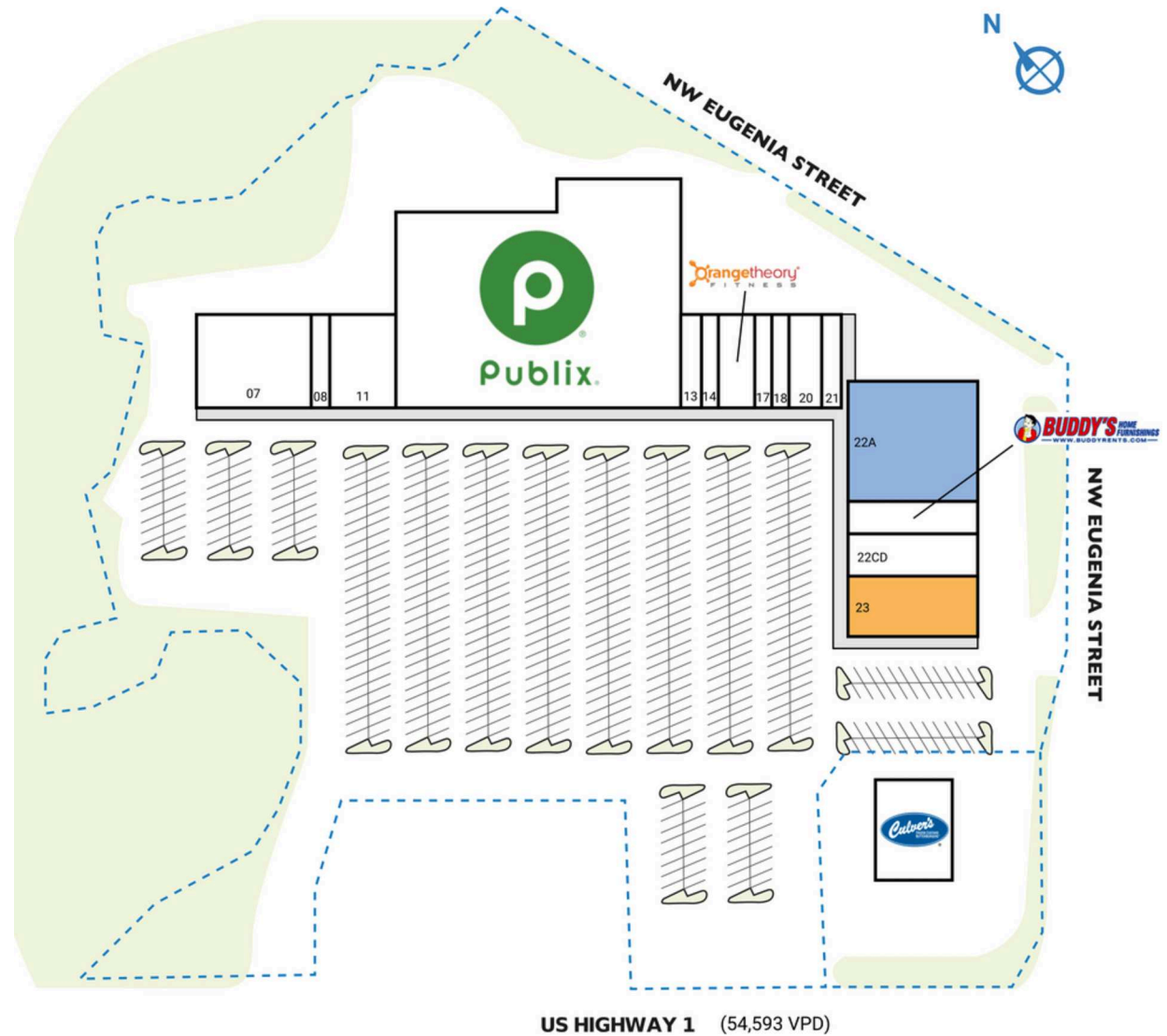

DISCLAIMER - This site plan is for general information purposes only and is not intended to constitute representations and warranties by Landlord as to the ownership of the real property depicted herein or the identity or nature of any occupants thereof.