

WINTER SPRINGS TOWN CENTER

WINTER SPRINGS, FL



SIZE

117,970 square feet

DEMOGRAPHICS

1 mile	3 mile	5 mile
Population		
7,915	42,191	145,710
Households		
3,126	16,319	55,118
Median HH Income (\$)		
107,240	89,303	81,056

MAJOR TENANT(S)

Publix
The UPS Store
Edward Jones



LOCATION

1160 E. State Road 434 | Winter Springs, FL 32708

PROPERTY HIGHLIGHTS

- Anchored by Publix
- E. State Road 434 serves as the main east/west artery linking with expressways I-4 and SR-417
- Located less than 2 miles from the Greenway Interchange District
- Population exceeds 39,300 in a three-mile radius with an average household income exceeding \$103,200
- Situated at the intersection of State Route 434 (23,003 VPD) and Bear Springs Drive

LEASING CONTACT

Jamie Pearson
Mobile (770) 355-0954
jpearson@phillipsedison.com

MORE INFO

www.phillipsedison.com



PHILLIPS EDISON & COMPANY®

WINTER SPRINGS TOWN CENTER

1160 E. State Road 434 | Winter Springs, FL 32708

SPACE	TENANT	SQ. FT.
A1204	Huey Magoo's	2,060 SF
A1206	TruEar	1,352 SF
A1207	COMING AVAILABLE	768 SF
A1208	Tijuana Flats Burrito Company	1,993 SF
A1214	COMING AVAILABLE	12,688 SF
B1300	Vietnamese Restaurant House	2,790 SF
B1304	Foxtail Coffee Co.	1,295 SF

B1308	Chiropractic Spine and Injury P.A.	1,530 SF
B1312	Authentic Church	1,335 SF
B1316	Thirst Teas	965 SF
B2320	AVAILABLE	4,887 SF
B2328	My Salon Suites	4,235 SF
C1132	Quest Diagnostics	1,699 SF
C1134	Edward Jones	1,136 SF
C1138	AVAILABLE	2,180 SF
C1142	Fabiola Camacho PLLC	1,500 SF

C1146	Pinch A Penny	2,500 SF
D1172	Red Bug Cleaners	1,159 SF
D1176	Winter Springs Center Nails	1,235 SF
D1182	Great Clips	1,200 SF
D1188	Rachel's Lash and Brow	1,190 SF
D1194	Jersey Mike's Subs	1,200 SF
E1171	Growing Together Pediatrics	5,250 SF
F1182	Dragon Vape	1,460 SF
F1184	Boba Garden	1,307 SF

F1188	The Greek Eatery	1,508 SF
F1192	Hawaiian Fluid Art	2,409 SF
F1196	Winter Springs Dentistry	1,400 SF
G1160	Publix	44,271 SF
H1164	Winter Springs Liquors	1,250 SF
H1170	The UPS Store	1,250 SF
H1174	Kava Culture Winter Springs	1,500 SF
J1168	Bella Luna's Pizzeria	1,400 SF
J1172	Sushi Delight and Bowl	1,100 SF

OUT1	Victoria Edward Spa & Wellness Center	2,968 SF
Shad1	CIG Tuskawilla Park	
Shad2	Devon Orlando	
Shad3	Victoria Edward Spa & Wellness Center	
TOTAL SQ. FT.		117,970

SITE LEGEND

- Available
- Occupied
- Leased (not occupied)
- Owned by Others
- Site Boundary

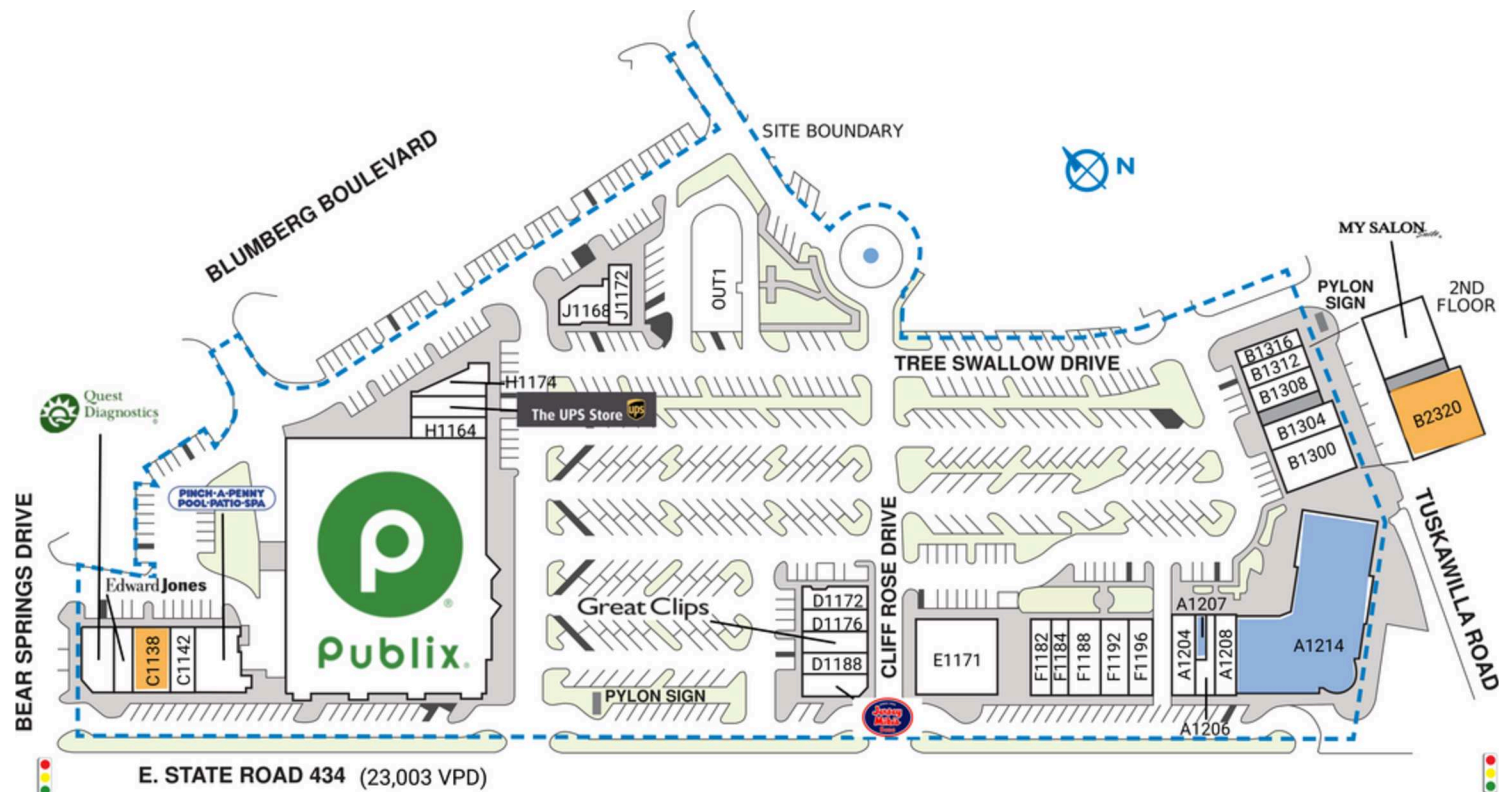

DISCLAIMER - This site plan is for general information purposes only and is not intended to constitute representations and warranties by Landlord as to the ownership of the real property depicted herein or the identity or nature of any occupants thereof.

WINTER SPRINGS TOWN CENTER

1160 E. State Road 434 | Winter Springs, FL 32708



WINTER SPRINGS TOWN CENTER

1160 E. State Road 434 | Winter Springs, FL 32708



Demographic Summary Report

1990 - 2000 Census, 2023 Estimates & 2028 Projections

Calculated using TAS Retrieval Retrieval

Apr 17, 2024



Latitude: 28.699267

Longitude: -81.264065

Winter Springs Town Center Winter Springs, FL		1.00 Mile Radius	3.00 Mile Radius	5.00 Mile Radius
Population	Q4 2023 Estimated Population	7,915	42,191	145,710
	2028 Projected Population	8,945	43,987	152,803
	2010 Census Population	4,782	35,472	121,444
	2000 Census Population	2,440	33,169	108,777
	1990 Census Population	2,016	22,594	86,264
	Historical Annual Growth 1990 to 2000	1.93%	3.91%	2.35%
	Historical Annual Growth 2000 to 2010	6.96%	0.67%	1.11%
	Estimated Annual Growth 2010 to 2023	3.73%	1.27%	1.33%
	Projected Annual Growth 2023 to 2028	2.48%	0.84%	0.96%
	Median Age	41.2	43.6	41.2
Households	Q4 2023 Estimated Households	3,126	16,319	55,118
	2028 Projected Households	3,537	17,036	57,830
	2010 Census Households	1,785	13,604	46,113
	2000 Census Households	852	11,974	39,222
	1990 Census Households	717	8,021	30,666
	Historical Annual Growth 1990 to 2000	1.74%	4.09%	2.49%
	Historical Annual Growth 2000 to 2010	7.67%	1.28%	1.63%
	Estimated Annual Growth 2010 to 2023	4.16%	1.33%	1.31%
	Projected Annual Growth 2023 to 2028	2.50%	0.86%	0.97%
	Population per Household	2.53	2.58	2.61
Population by Race	White	65.9%	66.5%	59.6%
	Black or African American	4.3%	5.2%	7.8%
	Asian & Pacific Islander	6.4%	4.4%	4.5%
	Other Races	4.9%	4.7%	4.6%
	Hispanic Population	18.4%	19.1%	23.4%
Income	Average Household Income	\$123,562	\$111,225	\$102,806
	Median Household Income	\$107,240	\$89,303	\$81,056
	Per Capita Income	\$48,796	\$43,035	\$39,274
Education (Age 25+)	Elementary	0.5%	1.6%	2.0%
	Some High School	1.0%	2.7%	3.7%
	High School Graduate	11.6%	15.1%	22.2%
	Some College	16.0%	19.2%	18.7%
	Associates Degree Only	9.9%	10.9%	11.8%
	Bachelors Degree Only	35.5%	31.9%	27.1%
	Graduate Degree	25.4%	18.7%	14.5%
Business	Number of Businesses	166	846	4,770
	Total Number of Employees	1,428	5,804	41,823
	Employees per Business	8.63	6.86	8.77
	Residential Population per Business	47.82	49.90	30.54

This report was produced using data from private and government sources deemed to be reliable and is herein provided without representation or warranty.