

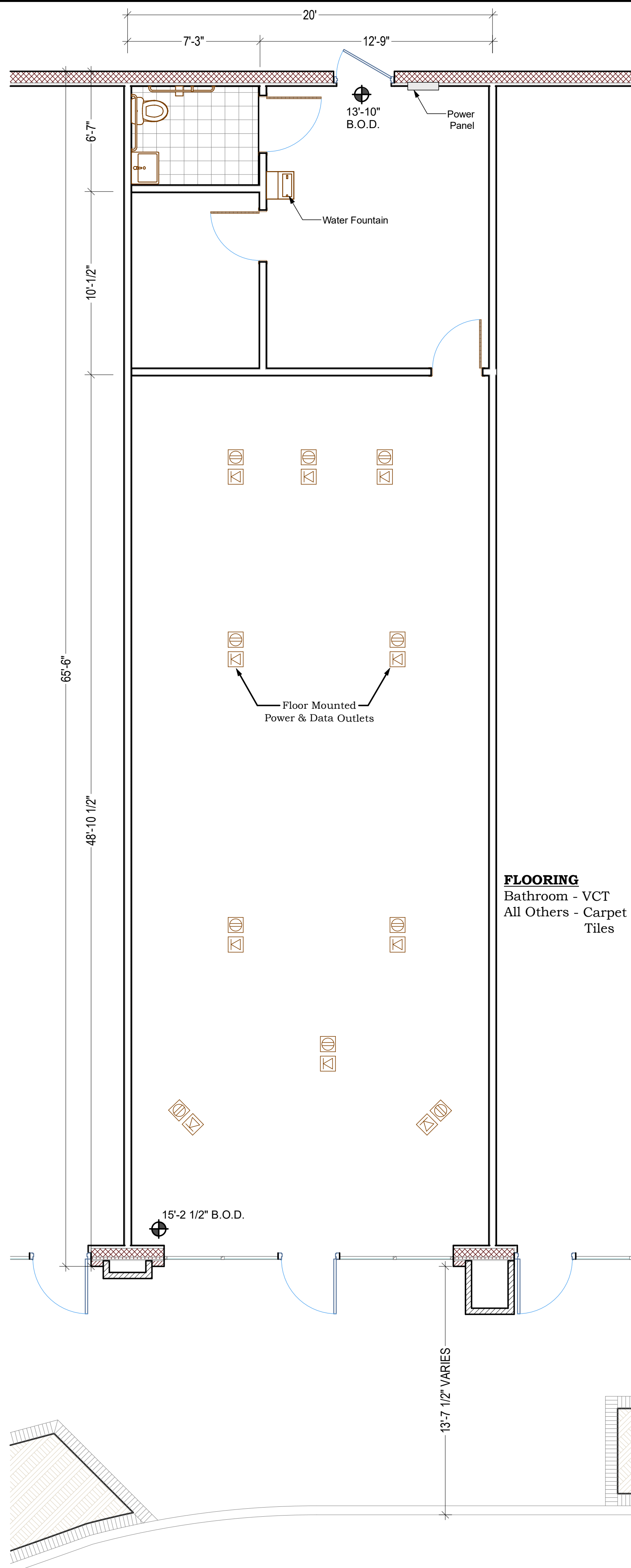

Front of Unit 620

NTS



FLOORING
 Bathroom - VCT
 All Others - Carpet
 Tiles

UNIT 620		1,300 SF
EXISTING FINISHES		
FLOORING	VCT - Bathroom CARPET TILE - All other	CONDITION GOOD/FAIR FAIR/POOR
WALLS		
	PAINT Note: Walls being Painted	GOOD/FAIR
WALL BASE		
	RUBBER	GOOD/POOR
CEILING		
	2' x 4' Layin	GOOD/FAIR
WINDOWS		
	ALUMINUM W/1" INSULATED GLAZING	GOOD

AMERICAN DISABILITIES COMPLIANCE	YES
CONSTRUCTION TYPE	TYPE III
BUILDING FIREPROOFED	YES
FIRE ALARM	NO
SPRINKLER SYSTEM	YES

CEILING HEIGHT	
BATHROOMS	8'-0"
ALL OTHER	9'-10"
NUMBER OF STORIES	
	1
DECK HEIGHT (at back of unit)	
	13'-10"

- NOTES:**
- THIS DRAWING IS FOR DIAGRAMMATIC PURPOSES ONLY AND IS INTENDED TO SHOW THE GENERAL CONFIGURATION OF THE SPACE.
 - ALL DIMENSIONS MUST BE FIELD VERIFIED BY THE TENANT OR THEIR CONTRACTOR.
 - ALL UTILITY LOCATIONS AND FIELD CONDITIONS MUST BE VERIFIED BY THE TENANT BEFORE THE DEVELOPMENT OF TENANT BUILD OUT DRAWINGS.

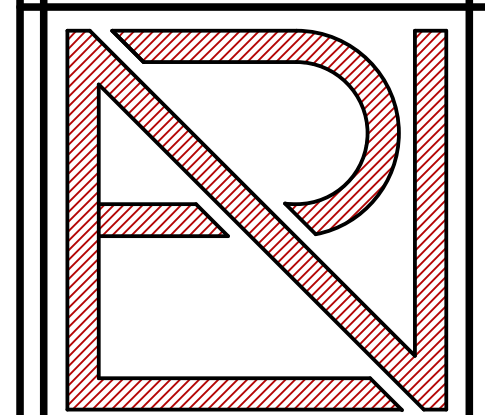

ROBERT NOBLE ARCHITECT A.I.A.
 119 SOUTH BROAD ST.
 ROME, GA 30161
 PH: (706) 295.2700
 FX: (706) 295.2063

NOT FOR CONSTRUCTION

PHILLIPS EDISON & CO
 RIVERMONT STATION - UNIT 620
 8465 HOLCOMB BRIDGE ROAD
 JOHNS CREEK, GEORGIA 30022

NOT FOR CONSTRUCTION

LOD Unit 620

PROJECT # 1827
 DRAWN BY:
 L. A. (Tony) LOMBARD
 DATE: 2 JAN 2019
 REV. DATE:

A1.1



Bathroom

NTS



208/120 Volt Elec. Panel

NTS



Meters at back of Unit 630

NTS

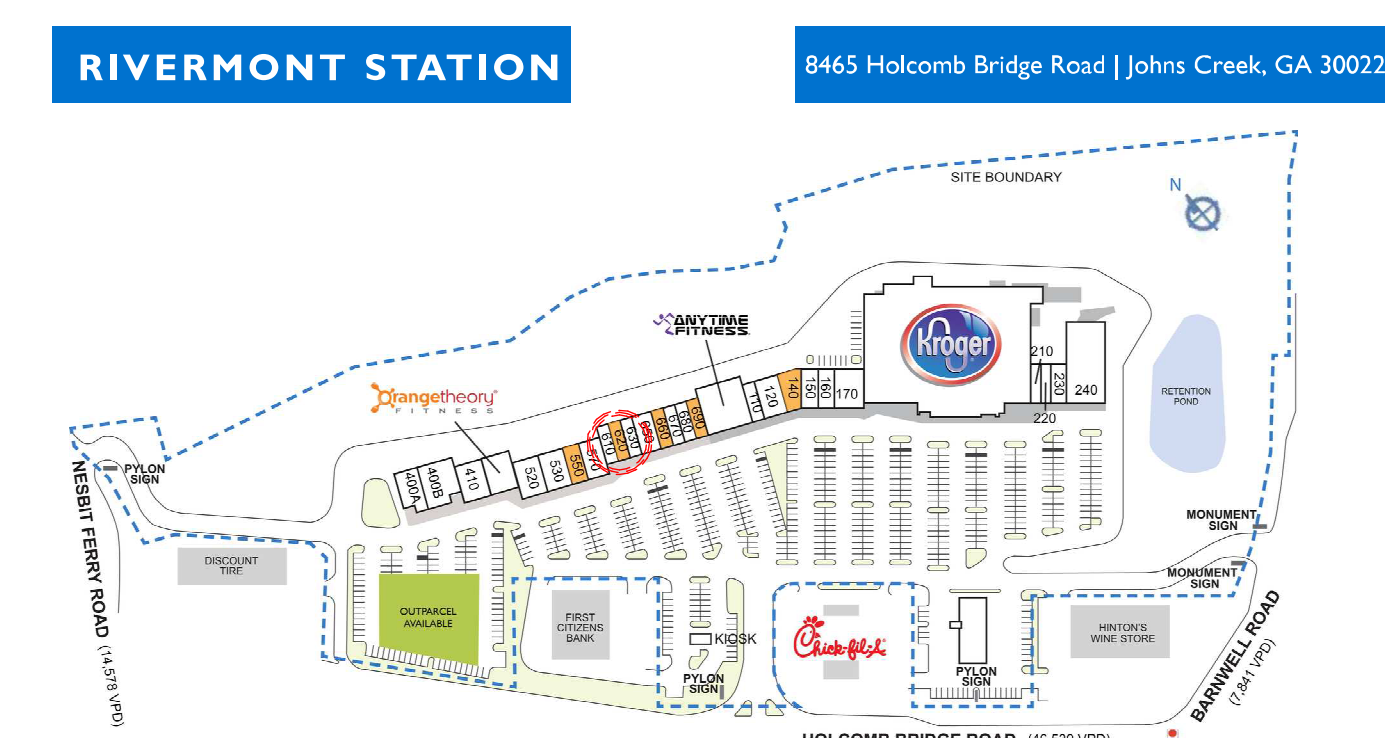

Site Plan
 Scale: NTS

Floor Plan

Scale: 1/4" = 1'