



NORTH

ISSUE DATE

04.27.16

REVISIONS

NO.	DESCRIPTION

PROJECT NUMBER

6051

Unit 12

SHEET NUMBER

AS2

VACINITY MAP



VACANT SPACE
(UNIT 12)



NORTH

DISCLAIMER:
THESE DOCUMENTS HAVE BEEN PREPARED FOR INFORMATION ONLY AND ARE NOT PROVIDED FOR CONSTRUCTION. ALL DIMENSIONS AND EXISTING CONDITIONS MUST BE FIELD VERIFIED PRIOR TO ANY CONSTRUCTION.

FIELD MEASUREMENTS ARE RECORDED TO THE NEAREST 1/32" AS DOCUMENTED IN THE FINAL CAD (.DWG) DOCUMENT. DIMENSIONS SHOWN ARE ROUNDED TO THE NEAREST 1" FOR CLARITY.

GENERAL INFORMATION:

NO. OF LEVELS: 1
BUILDING HEIGHT: N/A (INTERIOR SPACE)
(TOP OF PARAPET)
RESTROOM (ADA) COMPLIANCE: N/A

STRUCTURAL SPOT ELEVATIONS
*REFER TO PLAN FOR LOCATIONS

BJ = BOTTOM OF JOIST
BP = BOTTOM OF PURLIN
BB = BOTTOM OF BEAM
BD = BOTTOM OF METAL ROOF DECKING

FIRE ALARM: NO
FIRE PROTECTION (SPRINKER): YES

LEGEND

- HH/SH=4'-0" = HEAD HEIGHT / SILL HEIGHT
- ⊙ OH = DOOR WIDTH / TYPE
- ⊙ 3'-0" = SPOT ELEVATION
- ⊗ FE = FIRE EXTINGUISHER
- FA = FIRE ALARM (PULL STATION)
- FS = FIRE STROBE
- ⊙ CF = CEILING FAN



① **ELEVATION (PHOTO)**
1/8" = 1'-0"

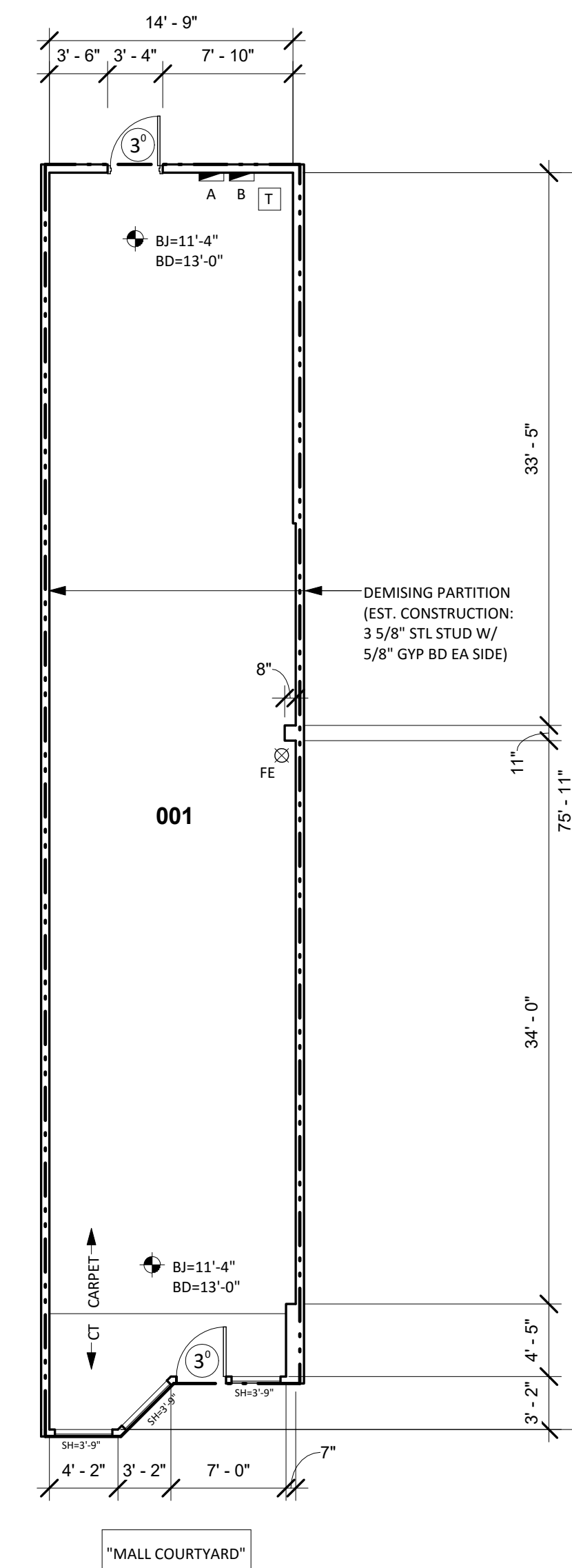

② **EXISTING FLOOR PLAN**
1/8" = 1'-0"

EXISTING ELECTRICAL SUMMARY

COMPONENT	MANUFACTURE	VOLTAGE	AMPS	PHASING	COMMENTS
PANELBOARD (A)	SEIMENS	208Y/120	200	3PH/4W	W/ MAIN SWITCH (200A)
PANELBOARD (B)	SEIMENS	208Y/120	250	3PH/4W	
TRANSFORMER (T)	SEIMENS	480	--	--	75 KVA

EXISTING FINISH/CONDITIONS SUMMARY (12)

ROOM	FLR MAT'L	FLR CONDITION	WALL MAT'L	WALL COND.	CLG MAT'L	CLG HGT	CLG COND.	ADD'L COMMENTS
001	CARPET	GOOD	WALLBOARD (PTD)	GOOD	ACT	8'-5"	GOOD	4" RUBBER BASE

NOTE
01) STOREFRONT: WOOD FRAME/GLASS (GOOD CONDITION)

CONDITION EVALUATION DEFINITION:
(GOOD) AVERAGE/ABOVE AVERAGE CONDITION. NO REMEDIAL WORK IS RECOMMENDED OR REQUIRED.
(FAIR) AVERAGE CONDITION. SOME WORK IS RECOMMENDED TO RETURN TO GOOD CONDITION
(POOR) BELOW AVERAGE CONDITION. SIGNIFICANT WORK SHOULD BE ANTICIPATED TO RESTORE