

VACINITY MAP



DISCLAIMER:
THESE DOCUMENTS HAVE BEEN PREPARED FOR INFORMATION ONLY AND ARE NOT PROVIDED FOR CONSTRUCTION. ALL DIMENSIONS AND EXISTING CONDITIONS MUST BE FIELD VERIFIED PRIOR TO ANY CONSTRUCTION.

FIELD MEASUREMENTS ARE RECORDED TO THE NEAREST 1/32" AS DOCUMENTED IN THE FINAL CAD (.DWG) DOCUMENT. DIMENSIONS SHOWN ARE ROUNDED TO THE NEAREST 1" FOR CLARITY.

GENERAL INFORMATION:

NO. OF LEVELS: 1
BUILDING HEIGHT: N/A (INTERIOR SPACE) (TOP OF PARAPET)
RESTROOM (ADA) COMPLIANCE: COMPLIANT
STRUCTURAL SPOT ELEVATIONS
*REFER TO PLAN FOR LOCATIONS
BJ = BOTTOM OF JOIST
BP = BOTTOM OF PURLIN
BB = BOTTOM OF BEAM
BD = BOTTOM OF METAL ROOF DECKING
FIRE ALARM: NO
FIRE PROTECTION (SPRINKER): YES

LEGEND

- HH/SH=4'-0" = HEAD HEIGHT / SILL HEIGHT
- ⊕
OH = DOOR WIDTH / TYPE
- ⊕
3'-0" = SPOT ELEVATION
- ⊗
FE = FIRE EXTINGUISHER
- FA = FIRE ALARM (PULL STATION)
- ⊙
FS = FIRE STROBE
- ⊙
CF = CEILING FAN



① ELEVATION (PHOTO)
1/8" = 1'-0"

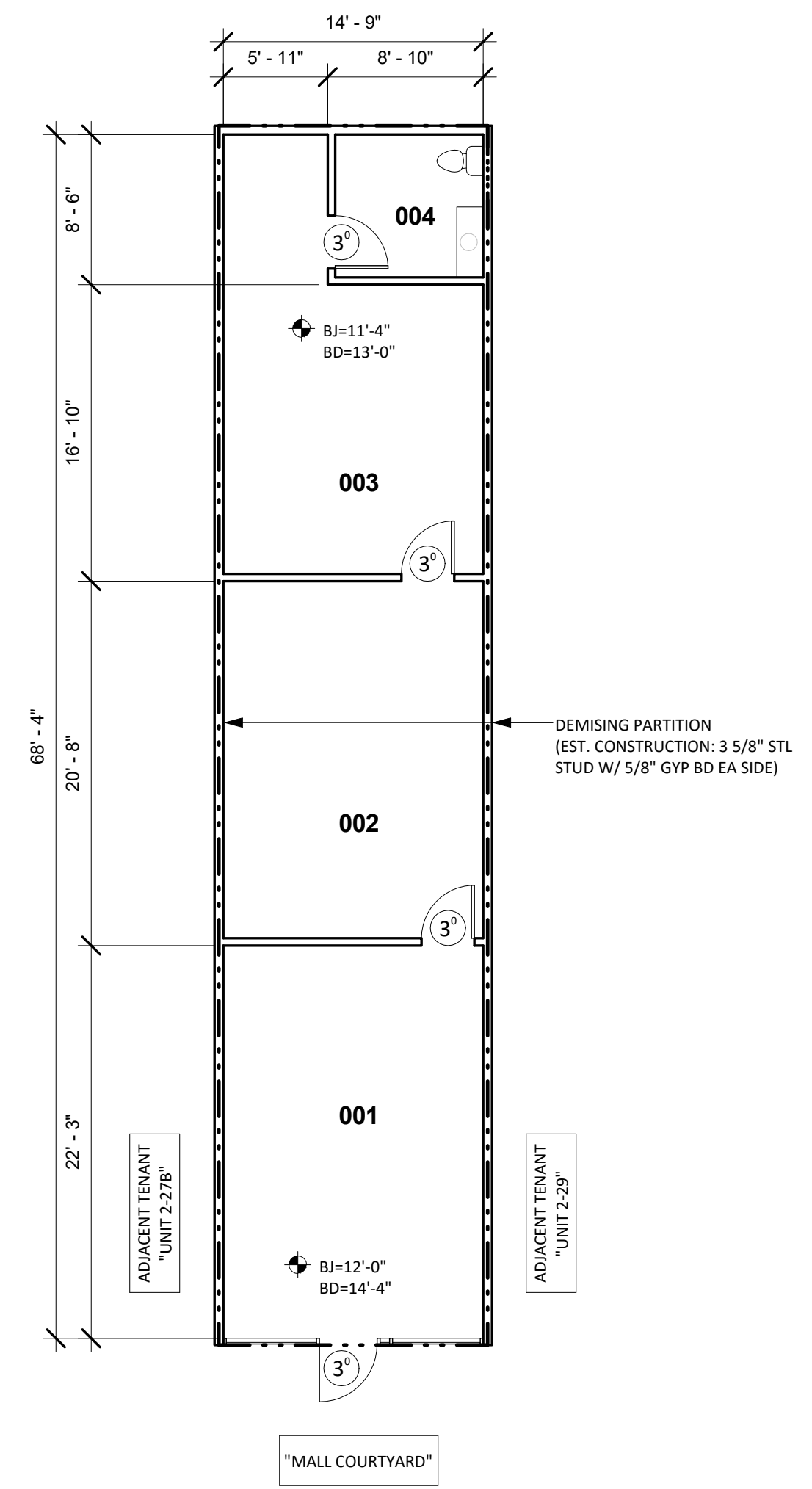

② EXISTING FLOOR PLAN
1/8" = 1'-0"

EXISTING ELECTRICAL SUMMARY

COMPONENT	MANUFACTURE	VOLTAGE	AMPS	PHASING	COMMENTS
N/A	N/A	N/A	N/A	N/A	NO ELEC PANEL IN SPACE

EXISTING FINISH/CONDITIONS SUMMARY (2-28)

ROOM	FLR MAT'L	FLR COND.	WALL MAT'L	WALL COND.	CLG MAT'L	CLG HGT	CLG COND.	ADD'L COMMENTS
001	CARPET	GOOD	WALLBOARD (PTD)	GOOD	ACT	9'-8"	GOOD	4" RUBBER BASE
002	CARPET	GOOD	WALLBOARD (PTD)	GOOD	ACT	9'-8"	GOOD	4" RUBBER BASE
003	CARPET	GOOD	WALLBOARD (PTD)	GOOD	ACT	9'-8"	GOOD	4" RUBBER BASE
004	VCT	GOOD	WALLBOARD (PTD)	GOOD	ACT	9'-8"	GOOD	4" RUBBER BASE

NOTE
01) STOREFRONT: DARK BRONZE/GLASS (GOOD CONDITION)

CONDITION EVALUATION DEFINITION:
(GOOD) AVERAGE/ABOVE AVERAGE CONDITION. NO REMEDIAL WORK IS RECOMMENDED OR REQUIRED.
(FAIR) AVERAGE CONDITION. SOME WORK IS RECOMMENDED TO RETURN TO GOOD CONDITION
(POOR) BELOW AVERAGE CONDITION. SIGNIFICANT WORK SHOULD BE ANTICIPATED TO RESTORE

NORTH

ISSUE DATE
04.27.16

REVISIONS

NO.	DESCRIPTION

PROJECT NUMBER
6051

Unit 2-28

SHEET NUMBER

AS6