

# STONE GATE PLAZA

1004 S. Crowley Rd. | Crowley, TX 76036

SPACE	TENANT	SQ. FT.
SHAD1	Wingstop	
SHAD2	Taco Bell	
SHAD4	Firestone	
SHAD5	AutoZone	
7	Cousin's Pit Barbeque	5,600 SF
9	Eagle Postal Center	1,400 SF
11	Pediatric Clinic	1,750 SF
13	Tobacco Plus	1,050 SF
15	Chen's Wok	1,400 SF
17	Papa John's Pizza	1,400 SF
19	AVAILABLE	1,400 SF
21	Pet Supplies Plus	6,860 SF
31	Subway	1,540 SF
33	Republic Finance	1,400 SF
35	Styles Hair Salon	1,400 SF
37	SOI BROW	1,400 SF
39	Nail Spa +	2,251 SF
42	Kroger	61,824 SF
TOTAL SQ. FT.		90,675

SITE LEGEND	
<span style="background-color: orange; border: 1px solid black; display: inline-block; width: 15px; height: 10px;"></span> Available	<span style="background-color: lightgray; border: 1px solid black; display: inline-block; width: 15px; height: 10px;"></span> Occupied
<span style="background-color: lightblue; border: 1px solid black; display: inline-block; width: 15px; height: 10px;"></span> Leased (not occupied)	<span style="background-color: gray; border: 1px solid black; display: inline-block; width: 15px; height: 10px;"></span> Owned by Others
<span style="border: 2px dashed blue; display: inline-block; width: 20px; height: 10px;"></span> Site Boundary	

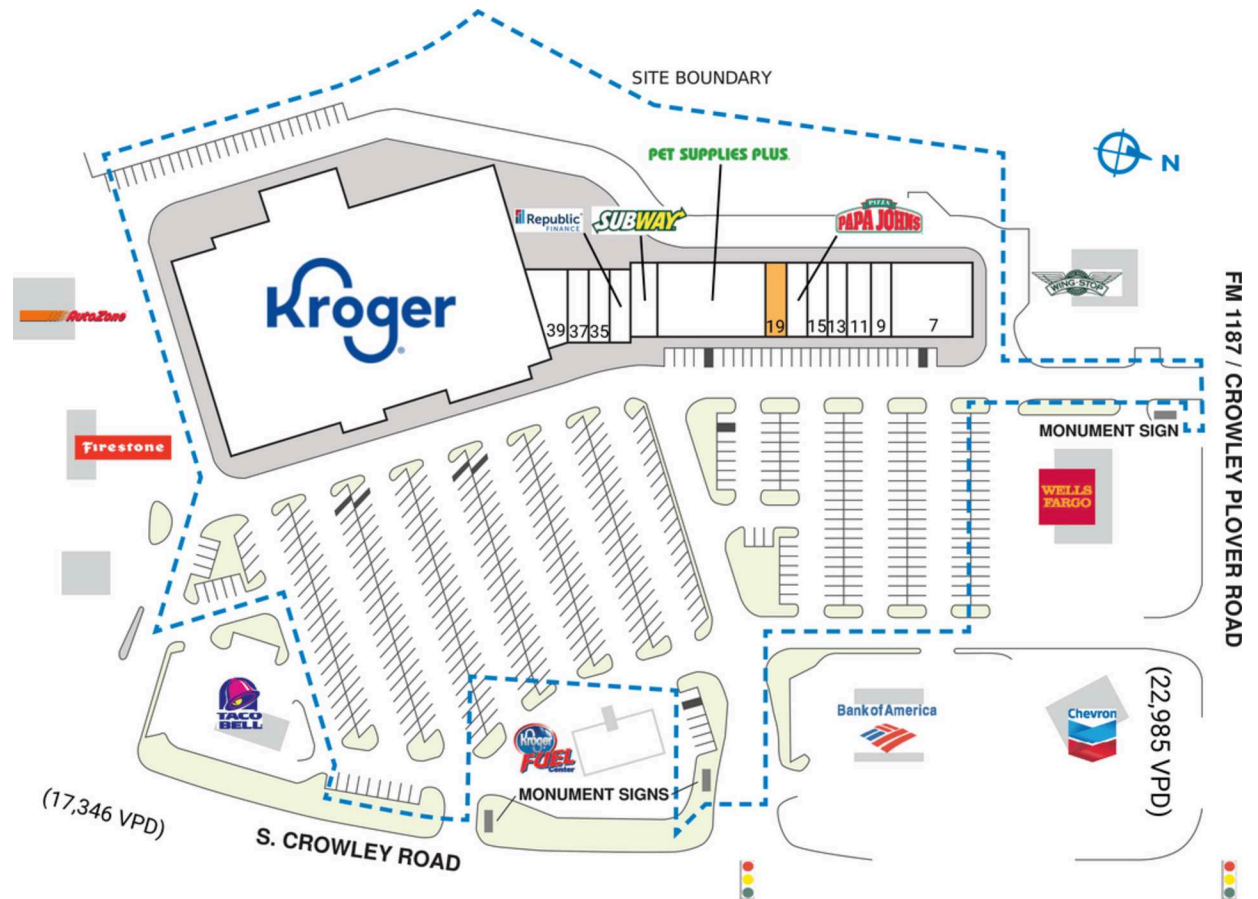

DISCLAIMER - This site plan is for general information purposes only and is not intended to constitute representations and warranties by Landlord as to the ownership of the real property depicted herein or the identity or nature of any occupants thereof.