

LAFAYETTE SQUARE

2224-2500 Teal Road | Lafayette, IN 47905

| SPACE | TENANT | SQ. FT. | STATUS | SQ. FT. |
|-------|---------------------------------|------------|---------------------------------|----------------|
| ATM | Purdue Federal Credit Union ATM | | 01200 AVAILABLE | 1,089 SF |
| OUT1 | Burger King | 3,200 SF | 01300 AVAILABLE | 1,300 SF |
| OUT2 | Wicked Food Shack | 540 SF | 01400 Monica Spa | 1,300 SF |
| OUT3 | Shell Gas Station | 2,212 SF | 01500 Discount Tobacco | 1,300 SF |
| 00100 | Rural King Supply | 103,161 SF | 01600 Chiffon's Beauty Supply | 3,510 SF |
| 00200 | Big Lots | 32,600 SF | 01900 Dollar Tree Family Dollar | 23,055 SF |
| 00300 | AVAILABLE | 8,361 SF | 02000 Humble Home | 25,470 SF |
| 00400 | Vicky's Beauty Salon | 1,032 SF | 02400 TNT Cleaners | 2,507 SF |
| 00500 | The Athlete | 6,774 SF | 02500 AVAILABLE | 1,200 SF |
| 00610 | Sherwin Williams | 6,000 SF | 02600 Road Star Driving School | 2,160 SF |
| 00700 | Xinia Furniture | 5,500 SF | 03400 Harvest Chapel | 13,042 SF |
| 00800 | En Lai Chinese Kitchen | 1,644 SF | 03500 COMING AVAILABLE | 1,149 SF |
| 01000 | Subway | 2,400 SF | TOTAL SQ. FT. | 250,506 |

| SITE LEGEND | |
|---|---|
| Available | Occupied |
| Leased (not occupied) | Owned by Others |
| Site Boundary | |

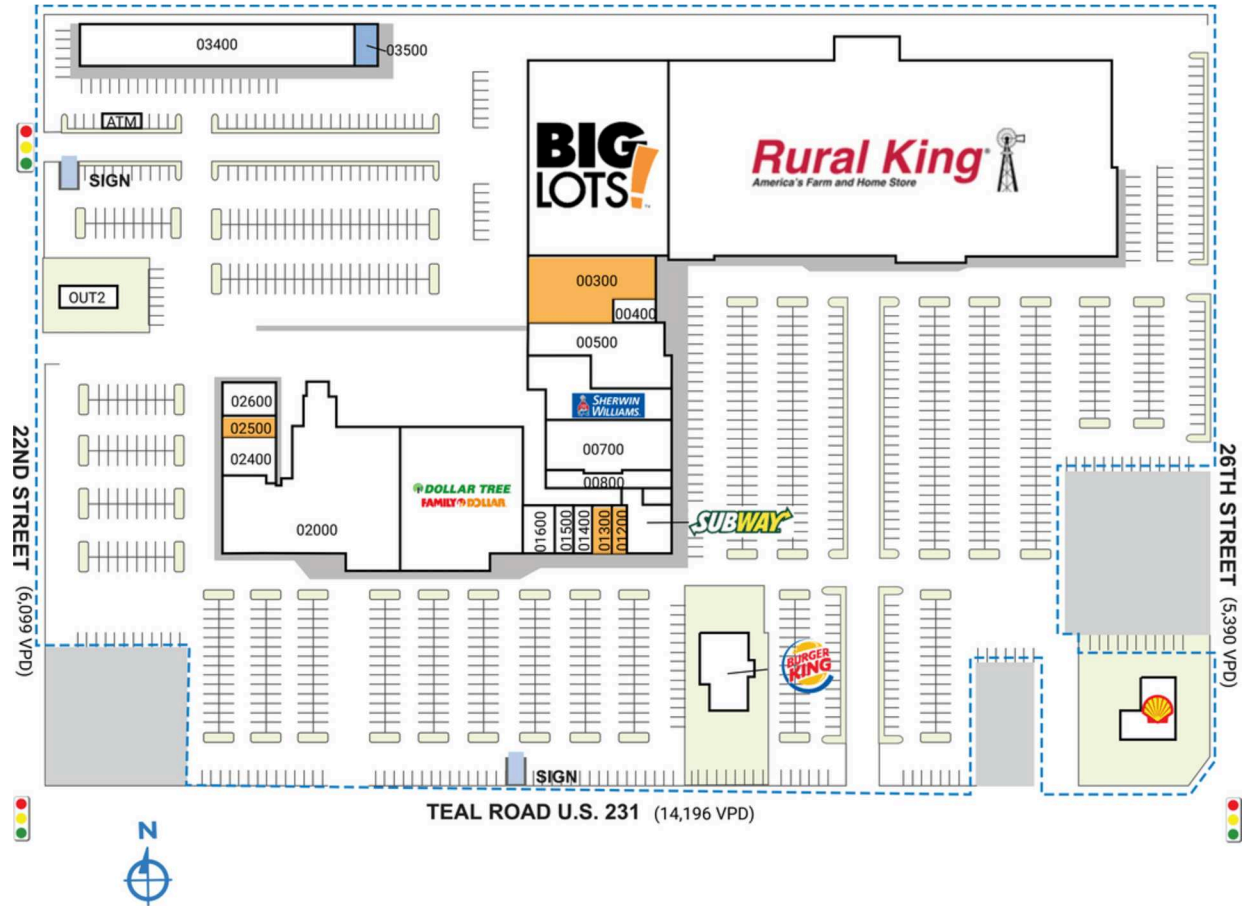

DISCLAIMER - This site plan is for general information purposes only and is not intended to constitute representations and warranties by Landlord as to the ownership of the real property depicted herein or the identity or nature of any occupants thereof.