



# POINT LOOMIS

3701 S. 27th Street | Milwaukee, WI 53221

SPACE	TENANT	SQ. FT.
51	Kohl's	80,731 SF
99	Pick 'n Save	76,129 SF
100	Dunkin'	1,500 SF
101	Tropical Smoothie Cafe	1,500 SF
102	Spectrum	4,000 SF
<b>TOTAL SQ. FT.</b>		<b>167,533</b>

**SITE LEGEND**

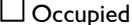
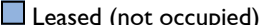
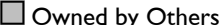
 Available	 Occupied
 Leased (not occupied)	 Owned by Others
 Site Boundary	

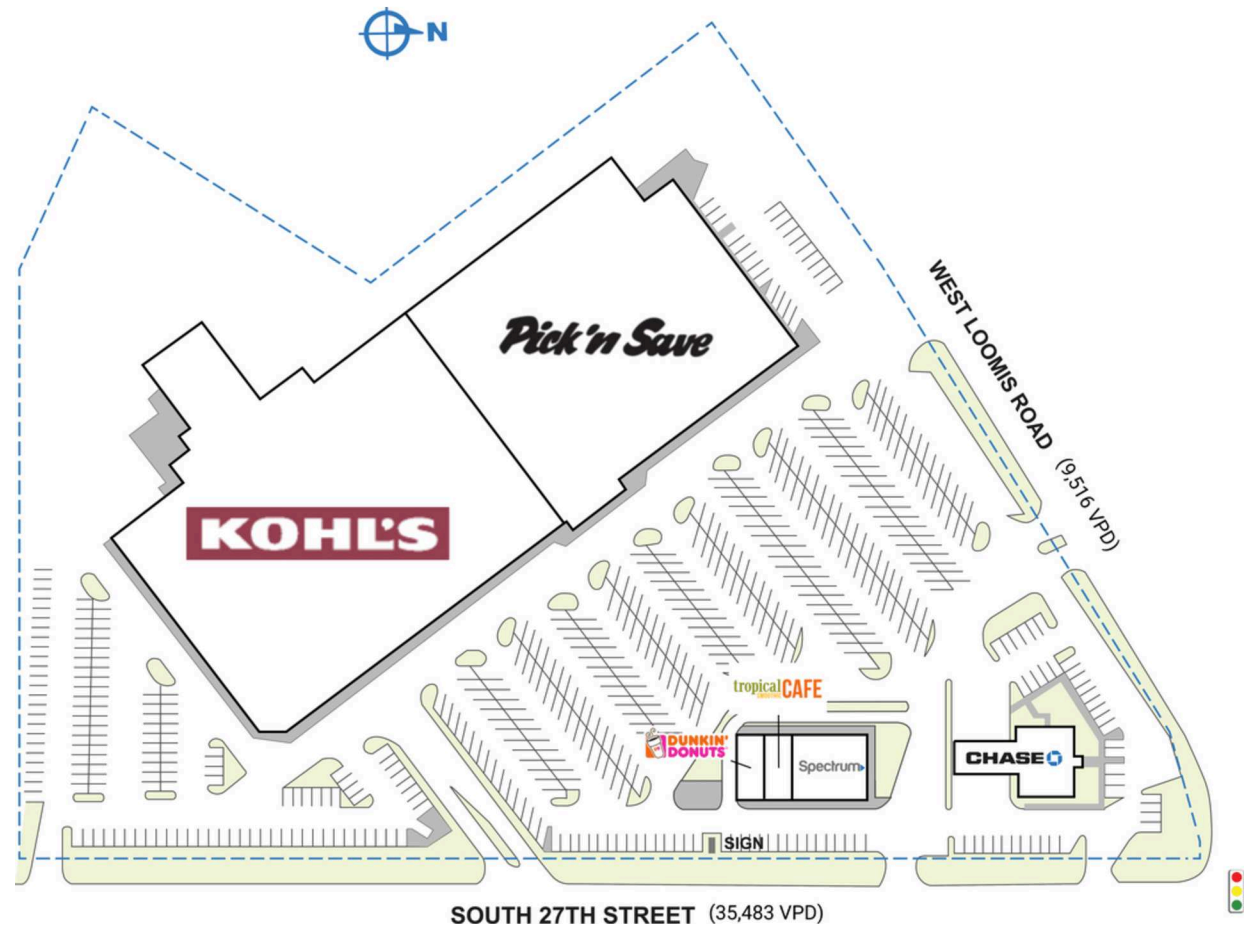

DISCLAIMER - This site plan is for general information purposes only and is not intended to constitute representations and warranties by Landlord as to the ownership of the real property depicted herein or the identity or nature of any occupants thereof.