

HOFFMAN VILLAGE

2575 Golf Road | Hoffman Estates, IL 60169

SPACE	TENANT	SQ. FT.	1199 Rock Star Nail Spa	4,350 SF	2535 Goodwill	20,630 SF	2571 Anytime Fitness	4,880 SF
SHADI	National Tire & Battery		2503 Marshall Nails and Spa	1,250 SF	2547 Forest View Animal Hospital	3,250 SF	2575 Mariano's	72,317 SF
1165	Jay Bhavani Vadapav	2,050 SF	2505 Best Dental Spa	2,211 SF	2551 COMING AVAILABLE	10,150 SF	2577 GNC	1,366 SF
1169	Gia's	1,575 SF	2509 Mustafa Coffee House	2,239 SF	2561 BVM Healthcare	3,990 SF	2579 Fannie May Candies	1,243 SF
1171A	Stella's	1,500 SF	2511 Russian School of Mathematics	2,069 SF	2565 Cafe Parlay	1,700 SF	TOTAL SQ. FT.	159,708
1171B	Salon Eros	1,500 SF	2515 Laundry World	6,425 SF	2567 COMING AVAILABLE	2,000 SF		
1173	Global Optical	1,500 SF	2527 Big Blue Swim School	8,453 SF	2569 HOCCO	2,000 SF		
1175	Vibrant Fusion	1,060 SF						

SITE LEGEND

- Available
- Occupied
- Leased (not occupied)
- Owned by Others
- Site Boundary

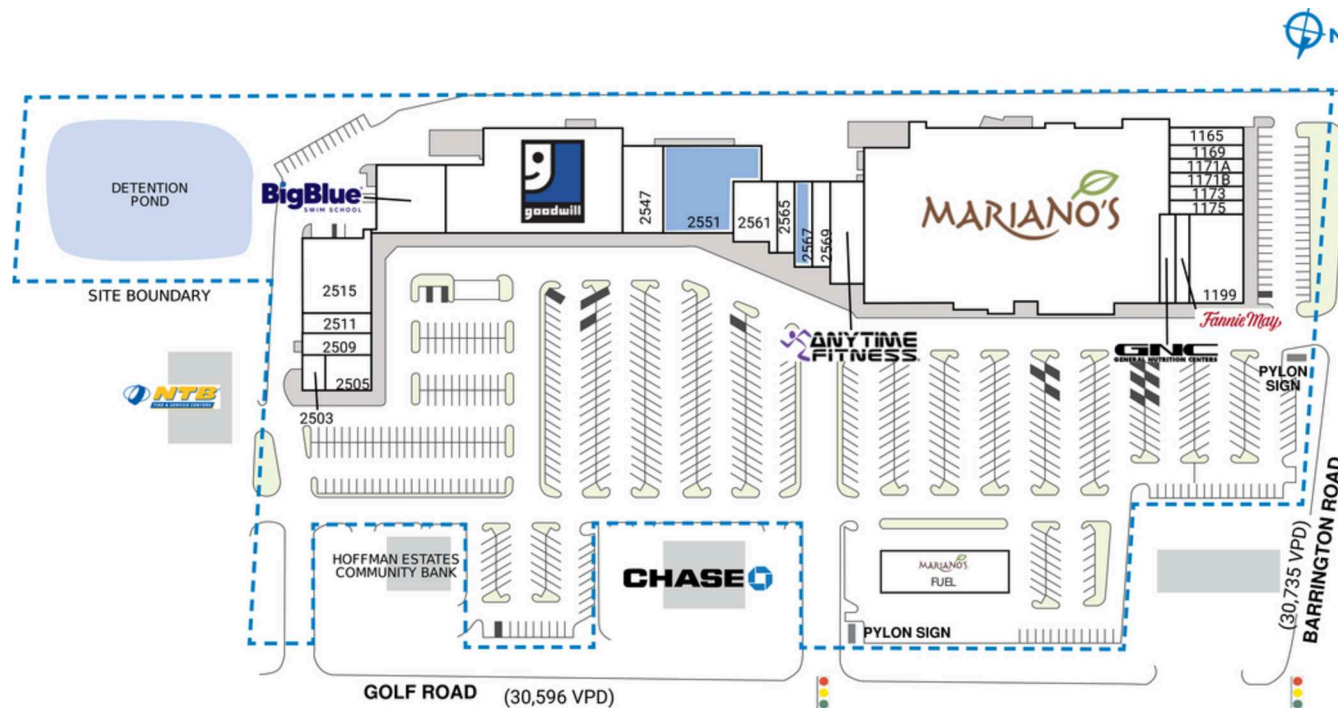

DISCLAIMER - This site plan is for general information purposes only and is not intended to constitute representations and warranties by Landlord as to the ownership of the real property depicted herein or the identity or nature of any occupants thereof.