

# BROADWAY PAVILION

SANTA MARIA, CA



## SIZE

142,676 square feet

## DEMOGRAPHICS

	1 mile	3 mile	5 mile
<b>Population</b>	16,309	79,284	145,682
<b>Households</b>	5,017	23,066	41,506
<b>Median HH Income (\$)</b>	93,021	80,595	84,054

## MAJOR TENANT(S)

Food Maxx  
Dollar Tree  
Starbucks



## LOCATION

2440 South Broadway | Santa Maria, CA 93454

## PROPERTY HIGHLIGHTS

- Anchored by FoodMaxx with Dollar Tree, Starbucks and Subway
- Located in Santa Maria with a population exceeding 79,200 in a three-mile radius
- Situated at the intersection of South Broadway and East McCoy Lane which benefits from more than 49,800 vehicles per day

## LEASING CONTACT

Ashley Selers  
Mobile (513) 633-0723  
aselers@phillipsedison.com

## MORE INFO

[www.phillipsedison.com](http://www.phillipsedison.com)



**PHILLIPS EDISON & COMPANY®**

# BROADWAY PAVILION

2440 South Broadway | Santa Maria, CA 93454

SPACE	TENANT	SQ. FT.		
2410	Dollar Tree	13,408 SF	2528A One Hour Valley Cleaners	1,500 SF
2410B	Idler's Home	17,873 SF	2528B Paradise Juice Bar	1,125 SF
2414	Santa Maria Thrift	6,000 SF	2528C Nolan Dental	3,033 SF
2426	Paragon of Santa Maria	4,000 SF	2530A D&A Hawaiian BBQ	1,725 SF
2430A	Starbucks	2,000 SF	2530B Revive Salon	2,025 SF
2430B	Nutrishop	1,280 SF	2530C Revive Salon 2	2,250 SF
2440	Food Maxx	49,950 SF	2530E AVAILABLE	1,125 SF
2502	Rent-A-Center	3,428 SF	2530F AVAILABLE	1,800 SF
2506	SESLOC Federal Credit Union	5,600 SF	2530G Taqueria La Unica	1,725 SF
2508	SB Restaurant	4,126 SF	2530H Baan Thai	1,125 SF
2512	New Image Thrift Store	9,446 SF	2530I Sassy Nails Lounge & Spa	1,357 SF
2524	La Luna Massage	1,870 SF	2530J Subway	1,275 SF
2526	Discount Cigarettes	1,530 SF	2530K One Life Fitness	2,100 SF
			<b>TOTAL SQ. FT.</b>	<b>142,676</b>

**SITE LEGEND**

- Available
- Leased (not occupied)
- Owned by Others
- Site Boundary
- Occupied

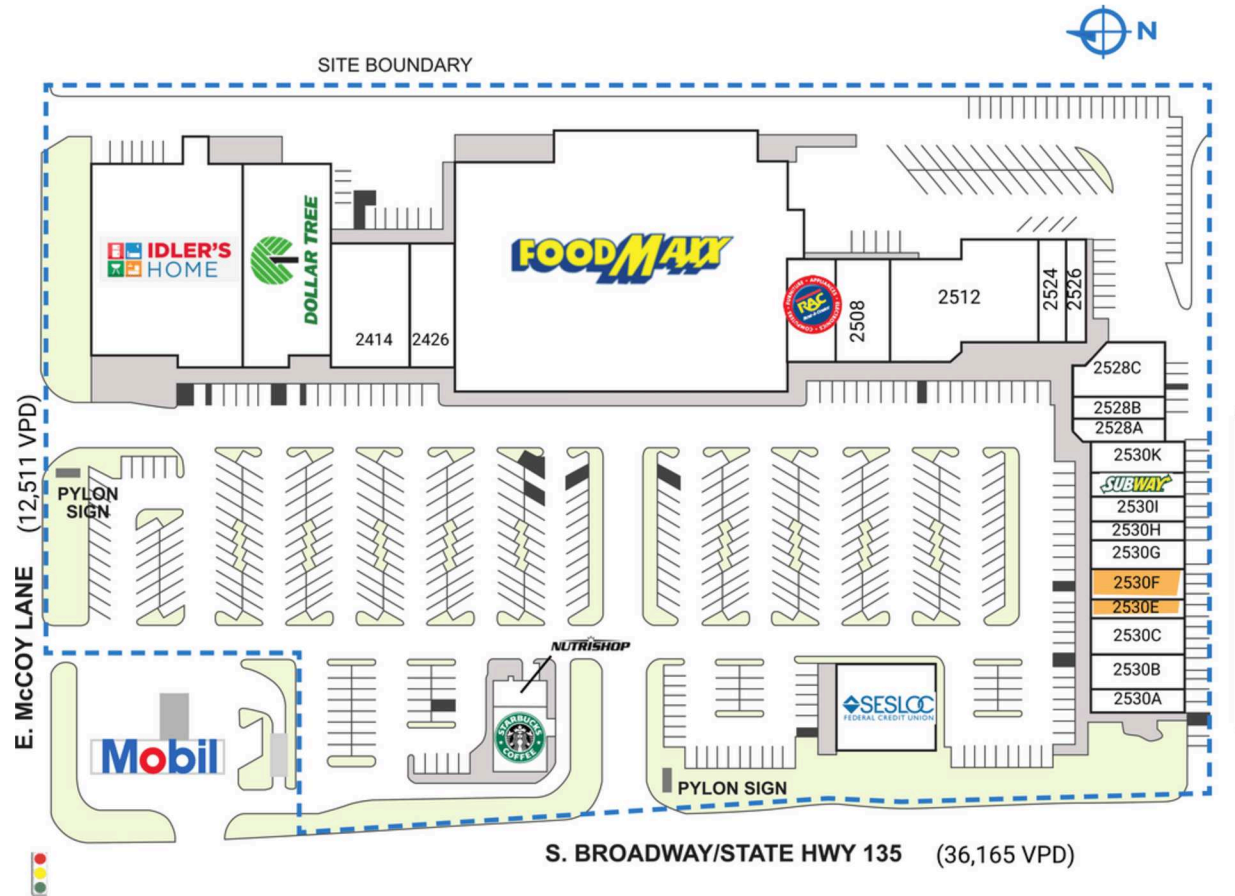

DISCLAIMER - This site plan is for general information purposes only and is not intended to constitute representations and warranties by Landlord as to the ownership of the real property depicted herein or the identity or nature of any occupants thereof.

# BROADWAY PAVILION

2440 South Broadway | Santa Maria, CA 93454



# BROADWAY PAVILION

2440 South Broadway | Santa Maria, CA 93454

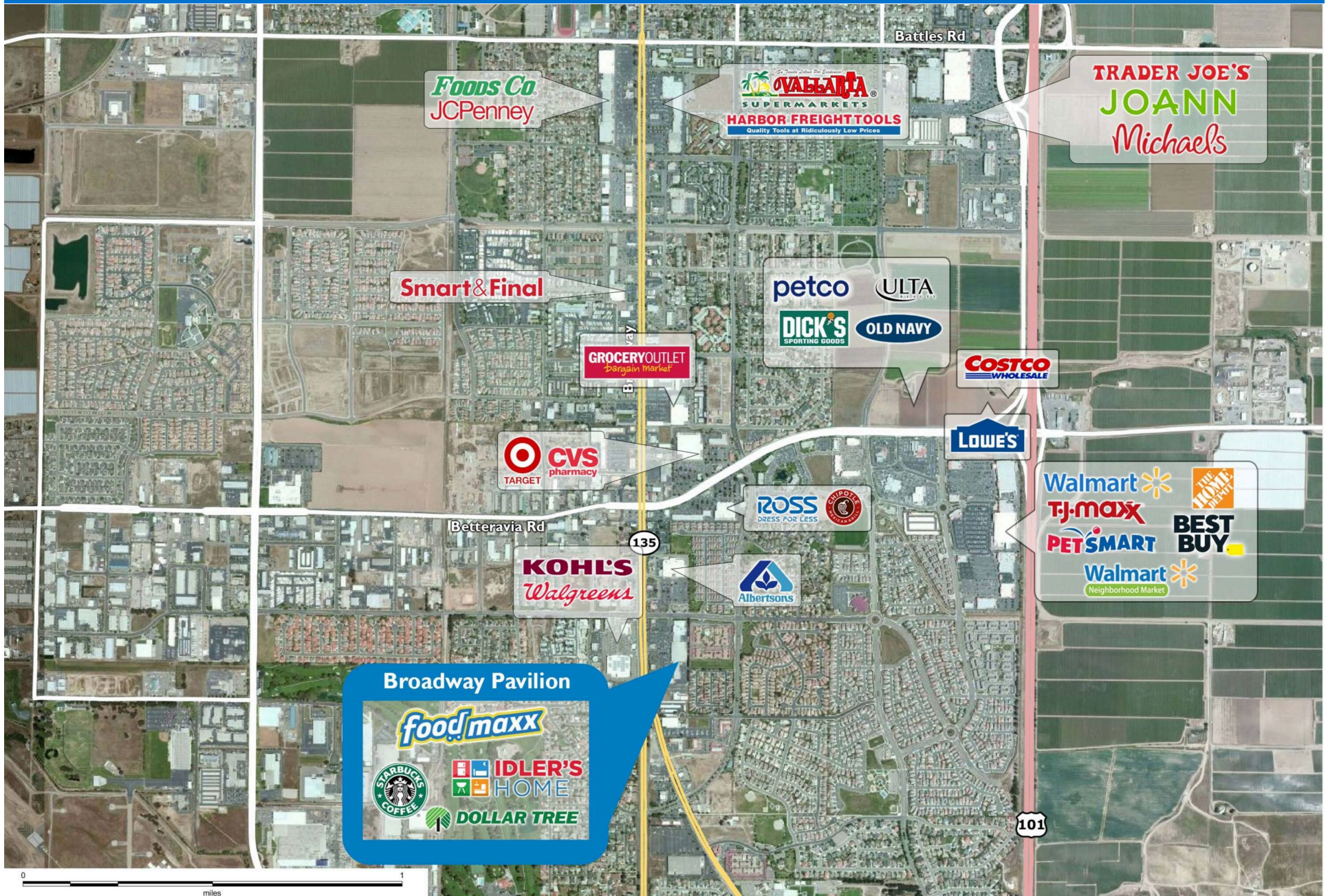

# Demographic Summary Report

1990 - 2000 Census, 2023 Estimates & 2028 Projections

Calculated using TAS Retrieval Retrieval

Apr 17, 2024



Latitude: 34.915216

Longitude: -120.434258

<b>Broadway Pavilion Santa Maria, CA</b>		<b>1.00 Mile Radius</b>	<b>3.00 Mile Radius</b>	<b>5.00 Mile Radius</b>
<b>Population</b>	Q4 2023 Estimated Population	16,309	79,284	145,682
	2028 Projected Population	17,031	81,512	151,296
	2010 Census Population	13,812	68,942	130,182
	2000 Census Population	9,153	56,285	109,677
	1990 Census Population	6,353	46,252	92,105
	Historical Annual Growth 1990 to 2000	3.72%	1.98%	1.76%
	Historical Annual Growth 2000 to 2010	4.20%	2.05%	1.73%
	Estimated Annual Growth 2010 to 2023	1.22%	1.02%	0.82%
	Projected Annual Growth 2023 to 2028	0.87%	0.56%	0.76%
	Median Age	35.0	33.2	34.3
<b>Households</b>	Q4 2023 Estimated Households	5,017	23,066	41,506
	2028 Projected Households	5,232	23,739	43,063
	2010 Census Households	4,550	20,696	38,029
	2000 Census Households	3,047	17,743	33,468
	1990 Census Households	2,275	16,342	30,654
	Historical Annual Growth 1990 to 2000	2.97%	0.83%	0.88%
	Historical Annual Growth 2000 to 2010	4.09%	1.55%	1.29%
	Estimated Annual Growth 2010 to 2023	0.71%	0.79%	0.64%
	Projected Annual Growth 2023 to 2028	0.84%	0.58%	0.74%
	Population per Household	3.24	3.41	3.49
<b>Population by Race</b>	White	27.7%	23.7%	24.6%
	Black or African American	1.8%	1.1%	1.1%
	Asian & Pacific Islander	6.8%	4.2%	4.2%
	Other Races	4.0%	3.1%	3.2%
	Hispanic Population	59.7%	67.9%	67.0%
<b>Income</b>	Average Household Income	\$111,964	\$102,034	\$103,726
	Median Household Income	\$93,021	\$80,595	\$84,054
	Per Capita Income	\$34,555	\$29,855	\$29,718
<b>Education (Age 25+)</b>	Elementary	13.7%	21.3%	21.0%
	Some High School	6.8%	8.7%	8.7%
	High School Graduate	22.9%	21.5%	21.4%
	Some College	21.6%	21.3%	21.7%
	Associates Degree Only	9.7%	8.7%	9.2%
	Bachelors Degree Only	18.4%	12.8%	12.0%
	Graduate Degree	6.9%	5.6%	6.1%
<b>Business</b>	Number of Businesses	778	2,934	3,815
	Total Number of Employees	8,490	34,142	44,909
	Employees per Business	10.91	11.64	11.77
	Residential Population per Business	20.96	27.03	38.19

This report was produced using data from private and government sources deemed to be reliable and is herein provided without representation or warranty.