



SIZE

167,533 square feet

DEMOGRAPHICS

	1 mile	3 mile	5 mile
Population	18,589	188,378	377,617
Households	7,326	72,256	157,246
Median HH Income (\$)	53,378	57,667	59,050

MAJOR TENANT(S)

Kohl's
Pick 'n Save



LOCATION

3701 S. 27th Street | Milwaukee, WI 53221

PROPERTY HIGHLIGHTS

- Anchored by Pick 'n Save, the number one grocer by market share in the Milwaukee metro area
- Additional national tenants include Kohl's and Chase Bank
- Located in Milwaukee, Wisconsin, with a population exceeding 188,300 in a three-mile radius
- The center is located at the intersection of 27th Street and Loomis Road which benefits from over 44,900 vehicles per day

LEASING CONTACT

Andy Schneider
Mobile (513) 417-4369
aschneider@phillipsedison.com

Kenneth Groh
Mobile (513) 344-4606
kgroh@phillipsedison.com

MORE INFO

www.phillipsedison.com





POINT LOOMIS

3701 S. 27th Street | Milwaukee, WI 53221

SPACE	TENANT	SQ. FT.
51	Kohl's	80,731 SF
65	Chase Bank	3,673 SF
99	Pick 'n Save	76,129 SF
100	Dunkin'	1,500 SF
101	Tropical Smoothie Cafe	1,500 SF
102	Spectrum	4,000 SF
TOTAL SQ. FT.		167,533

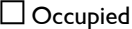
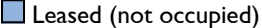
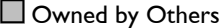
SITE LEGEND

 Available	 Occupied
 Leased (not occupied)	 Owned by Others
 Site Boundary	

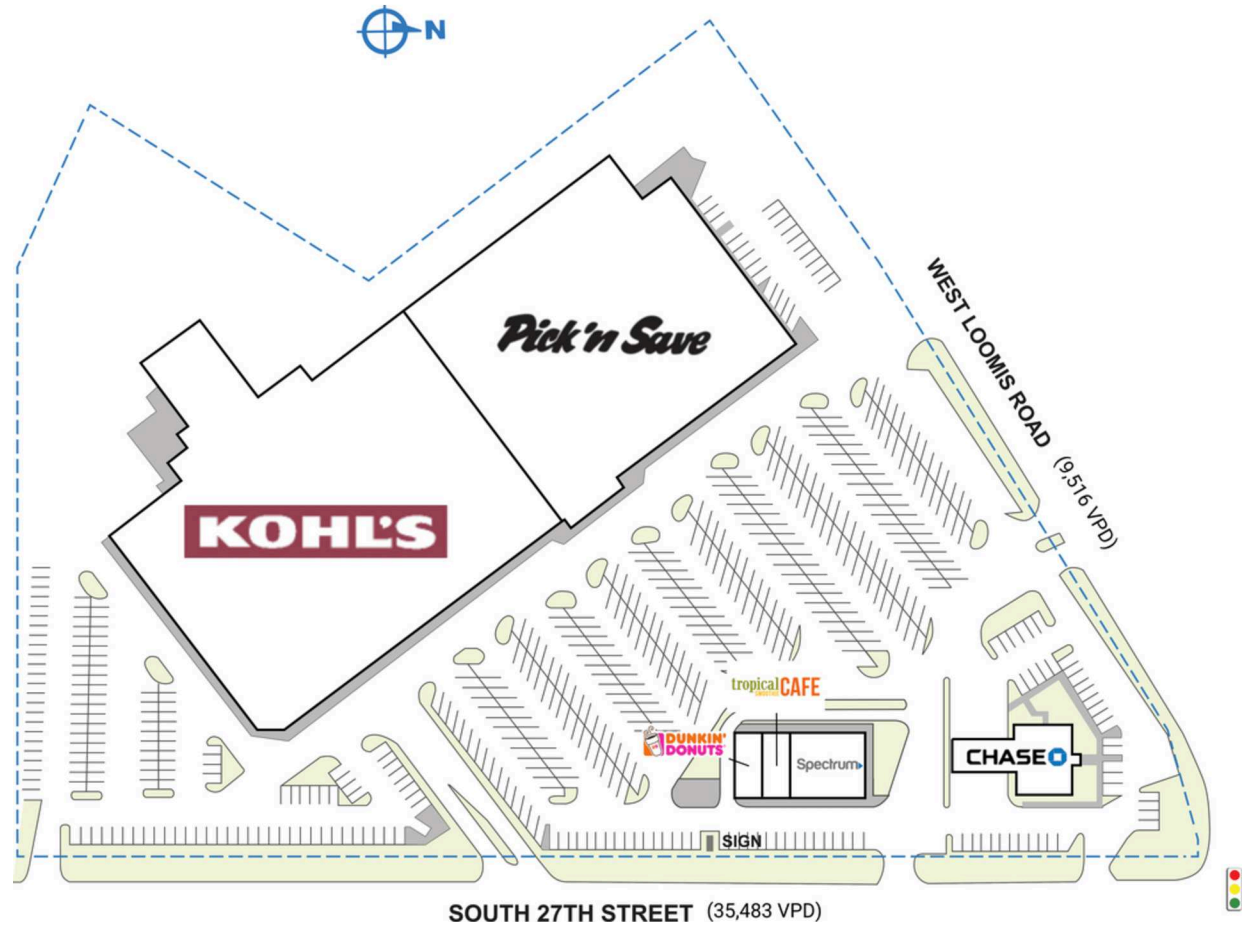

DISCLAIMER - This site plan is for general information purposes only and is not intended to constitute representations and warranties by Landlord as to the ownership of the real property depicted herein or the identity or nature of any occupants thereof.

POINT LOOMIS

3701 S. 27th Street | Milwaukee, WI 53221

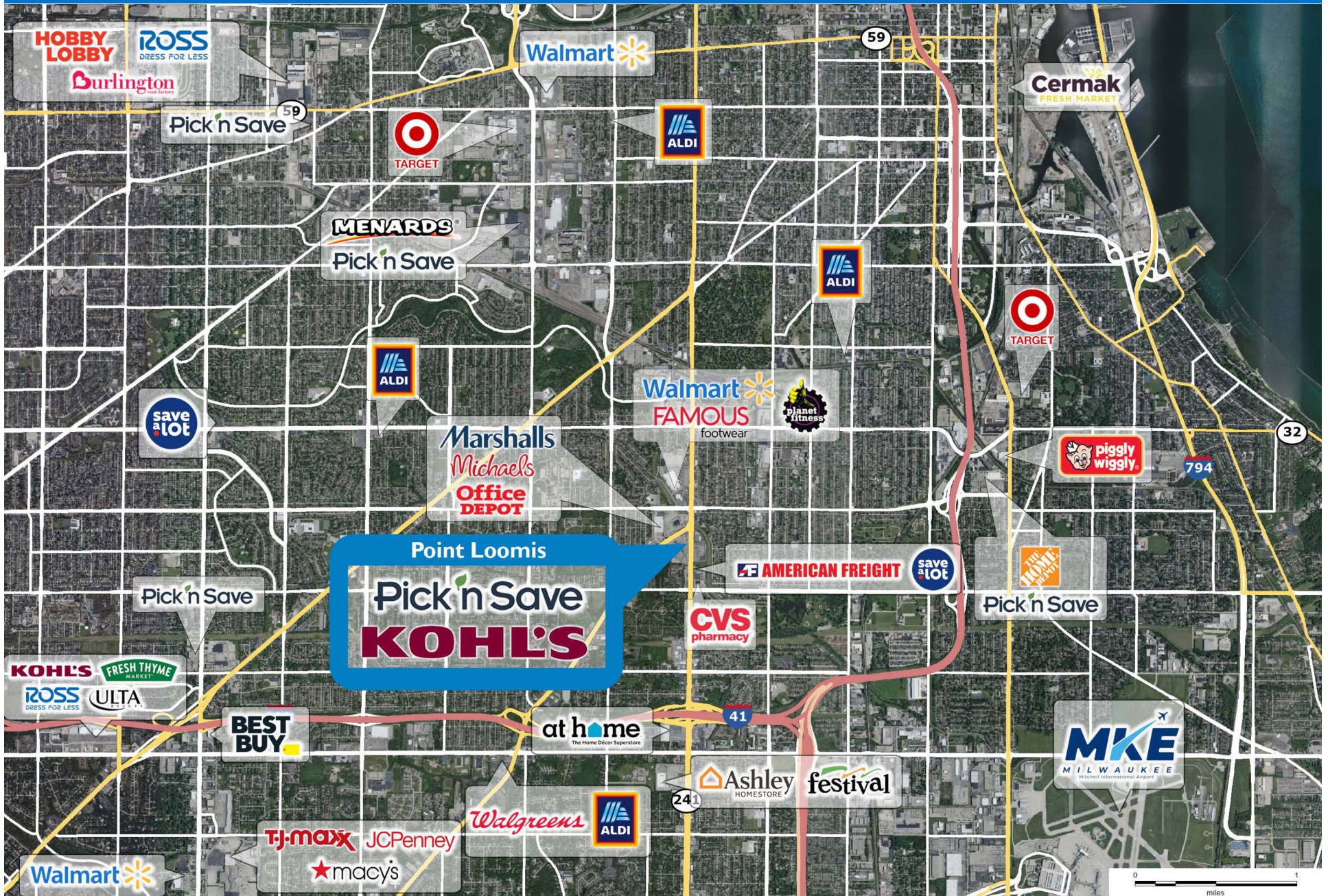

Demographic Summary Report

1990 - 2000 Census, 2023 Estimates & 2028 Projections

Calculated using TAS Retrieval Retrieval

Apr 17, 2024



Latitude: 42.977644

Longitude: -87.950483

Point Loomis Milwaukee, WI		1.00 Mile Radius	3.00 Mile Radius	5.00 Mile Radius
Population	Q4 2023 Estimated Population	18,589	188,378	377,617
	2028 Projected Population	18,388	188,732	380,845
	2010 Census Population	17,430	189,887	377,959
	2000 Census Population	15,686	180,751	368,104
	1990 Census Population	15,591	177,415	374,220
	Historical Annual Growth 1990 to 2000	0.06%	0.19%	-0.16%
	Historical Annual Growth 2000 to 2010	1.06%	0.49%	0.26%
	Estimated Annual Growth 2010 to 2023	0.47%	-0.06%	-0.01%
	Projected Annual Growth 2023 to 2028	-0.22%	0.04%	0.17%
	Median Age	36.3	36.3	36.8
Households	Q4 2023 Estimated Households	7,326	72,256	157,246
	2028 Projected Households	7,240	72,216	158,687
	2010 Census Households	7,319	71,670	152,226
	2000 Census Households	7,180	71,301	149,521
	1990 Census Households	6,979	71,092	148,792
	Historical Annual Growth 1990 to 2000	0.28%	0.03%	0.05%
	Historical Annual Growth 2000 to 2010	0.19%	0.05%	0.18%
	Estimated Annual Growth 2010 to 2023	0.01%	0.06%	0.24%
	Projected Annual Growth 2023 to 2028	-0.24%	-0.01%	0.18%
	Population per Household	2.50	2.59	2.34
Population by Race	White	38.7%	41.6%	51.7%
	Black or African American	8.0%	5.5%	8.5%
	Asian & Pacific Islander	8.1%	5.0%	4.5%
	Other Races	4.3%	3.8%	4.5%
	Hispanic Population	40.8%	44.0%	30.9%
Income	Average Household Income	\$65,829	\$71,435	\$75,451
	Median Household Income	\$53,378	\$57,667	\$59,050
	Per Capita Income	\$26,322	\$27,602	\$31,888
Education (Age 25+)	Elementary	7.9%	9.7%	6.3%
	Some High School	7.7%	9.7%	7.8%
	High School Graduate	30.9%	32.2%	30.8%
	Some College	25.2%	19.5%	20.0%
	Associates Degree Only	9.6%	7.4%	8.1%
	Bachelors Degree Only	12.9%	14.9%	18.2%
	Graduate Degree	5.7%	6.6%	8.8%
Business	Number of Businesses	890	3,806	11,543
	Total Number of Employees	13,405	52,252	196,491
	Employees per Business	15.07	13.73	17.02
	Residential Population per Business	20.90	49.50	32.71

This report was produced using data from private and government sources deemed to be reliable and is herein provided without representation or warranty.