

12 WEST MARKETPLACE

LITCHFIELD, MN



SIZE

82,911 square feet

DEMOGRAPHICS

| | 1 mile | 3 mile | 5 mile |
|------------------------------|--------|--------|--------|
| Population | 3,555 | 7,247 | 8,236 |
| Households | 1,900 | 3,887 | 4,098 |
| Median HH Income (\$) | 61,090 | 63,189 | 65,502 |

MAJOR TENANT(S)

Running's Farm and Fleet
Family Fare
Fantastic Sams

LEASING CONTACT

Andy Schneider
Mobile (513) 417-4369
aschneider@phillipsedison.com

Kenneth Groh
Mobile (513) 344-4606
kgroh@phillipsedison.com

MORE INFO

www.phillipsedison.com

LOCATION

951-975 E Frontage Rd. | Litchfield, MN 55355

PROPERTY HIGHLIGHTS

- Anchored by Family Fare and Running's Farm and Fleet
- Highly visible from U.S. 12
- 30+ mile trade area
- Restaurant pad available
- Median Household Income exceeds \$65,500 in a 5-mile radius

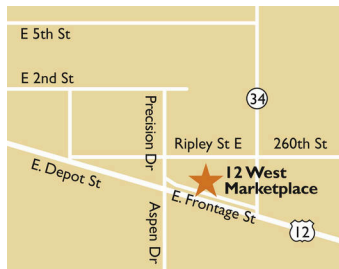

PHILLIPS EDISON & COMPANY®

12 WEST MARKETPLACE

951-975 E Frontage Rd. | Litchfield, MN 55355

| SPACE | TENANT | SQ. FT. |
|----------------------|------------------------------------|---------------|
| 00951 | Family Fare | 32,706 SF |
| 00957 | Fantastic Sams | 1,050 SF |
| 00959 | Honey Bee Dance Studio | 3,692 SF |
| 00967 | Hacienda Family Mexican Restaurant | 2,342 SF |
| 00971 | H&R Block | 2,321 SF |
| 00975 | Running's Farm and Fleet | 40,800 SF |
| TOTAL SQ. FT. | | 82,911 |

| SITE LEGEND | |
|---|--|
| Available | Occupied |
| Leased (not occupied) | Owned by Others |
| Site Boundary | |

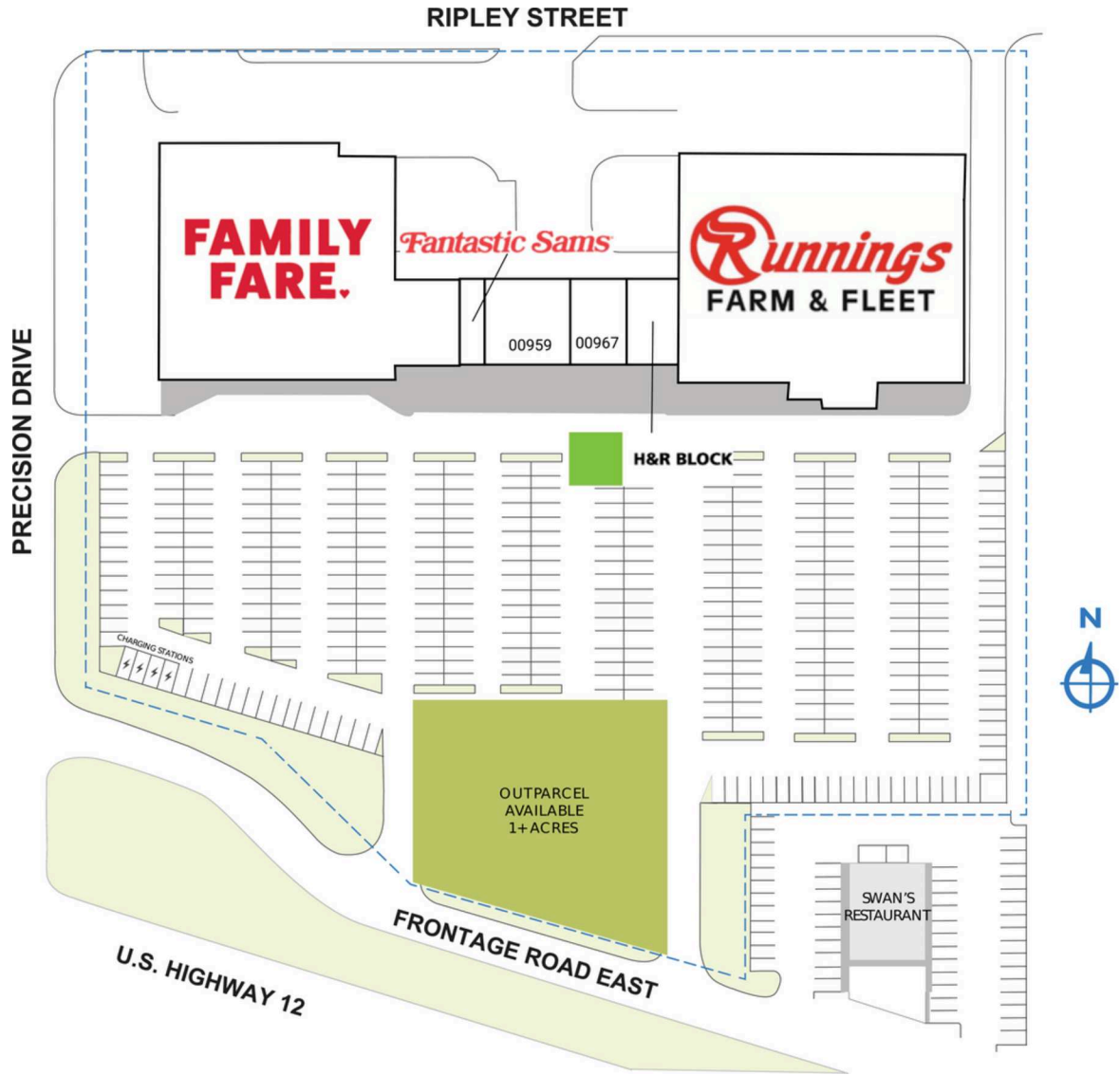

DISCLAIMER - This site plan is for general information purposes only and is not intended to constitute representations and warranties by Landlord as to the ownership of the real property depicted herein or the identity or nature of any occupants thereof.

I2 WEST MARKETPLACE

951-975 E Frontage Rd. | Litchfield, MN 55355



12 WEST MARKETPLACE

951-975 E Frontage Rd. | Litchfield, MN 55355



Demographic Summary Report

1990 - 2000 Census, 2023 Estimates & 2028 Projections

Calculated using TAS Retrieval Retrieval

Apr 17, 2024



Latitude: 45.12289

Longitude: -94.507733

| 12 West Marketplace Litchfield, Mn | | 1.00 Mile Radius | 3.00 Mile Radius | 5.00 Mile Radius |
|---------------------------------------|---------------------------------------|------------------|------------------|------------------|
| Population | Q4 2023 Estimated Population | 3,555 | 7,247 | 8,236 |
| | 2028 Projected Population | 3,441 | 7,013 | 7,972 |
| | 2010 Census Population | 3,491 | 7,294 | 8,250 |
| | 2000 Census Population | 3,399 | 7,156 | 8,122 |
| | 1990 Census Population | 3,125 | 6,601 | 7,460 |
| | Historical Annual Growth 1990 to 2000 | 0.84% | 0.81% | 0.85% |
| | Historical Annual Growth 2000 to 2010 | 0.27% | 0.19% | 0.16% |
| | Estimated Annual Growth 2010 to 2023 | 0.13% | -0.05% | -0.01% |
| | Projected Annual Growth 2023 to 2028 | -0.65% | -0.65% | -0.65% |
| | Median Age | 43.4 | 42.7 | 43.3 |
| Households | Q4 2023 Estimated Households | 1,416 | 2,961 | 3,367 |
| | 2028 Projected Households | 1,367 | 2,861 | 3,255 |
| | 2010 Census Households | 1,442 | 2,977 | 3,363 |
| | 2000 Census Households | 1,336 | 2,829 | 3,192 |
| | 1990 Census Households | 1,202 | 2,600 | 2,907 |
| | Historical Annual Growth 1990 to 2000 | 1.07% | 0.85% | 0.94% |
| | Historical Annual Growth 2000 to 2010 | 0.76% | 0.51% | 0.52% |
| | Estimated Annual Growth 2010 to 2023 | -0.13% | -0.04% | 0.01% |
| | Projected Annual Growth 2023 to 2028 | -0.70% | -0.68% | -0.68% |
| | Population per Household | 2.36 | 2.35 | 2.36 |
| Population by Race | White | 93.3% | 89.6% | 90.0% |
| | Black or African American | 0.4% | 0.4% | 0.4% |
| | Asian & Pacific Islander | 0.2% | 0.1% | 0.1% |
| | Other Races | 1.9% | 2.5% | 2.4% |
| | Hispanic Population | 4.2% | 7.4% | 7.1% |
| Income | Average Household Income | \$92,156 | \$90,518 | \$91,724 |
| | Median Household Income | \$61,090 | \$63,189 | \$65,502 |
| | Per Capita Income | \$38,405 | \$38,145 | \$38,534 |
| Education (Age 25+) | Elementary | 1.5% | 1.3% | 1.3% |
| | Some High School | 3.2% | 3.7% | 3.5% |
| | High School Graduate | 33.4% | 35.9% | 35.8% |
| | Some College | 24.1% | 23.5% | 23.1% |
| | Associates Degree Only | 18.7% | 16.9% | 17.0% |
| | Bachelors Degree Only | 12.3% | 13.2% | 13.6% |
| | Graduate Degree | 6.9% | 5.5% | 5.8% |
| Business | Number of Businesses | 158 | 328 | 347 |
| | Total Number of Employees | 1,900 | 3,887 | 4,098 |
| | Employees per Business | 12.00 | 11.86 | 11.82 |
| | Residential Population per Business | 22.45 | 22.11 | 23.75 |

This report was produced using data from private and government sources deemed to be reliable and is herein provided without representation or warranty.